

REV.	CHANGE CONTENT	BY	DATE

PINS ASSIGNMENTS	
PIN	SYMBOL
1	VSS
2	VDD
3	NC
4	RS
5	R/W
6	E
7	DB0
8	DB1
9	DB2
10	DB3
11	DB4
12	DB5
13	DB6
14	DB7
15	PSB
16	NC
17	/RST
18	NC
19	LEDA
20	LEDB

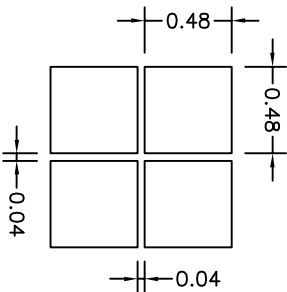
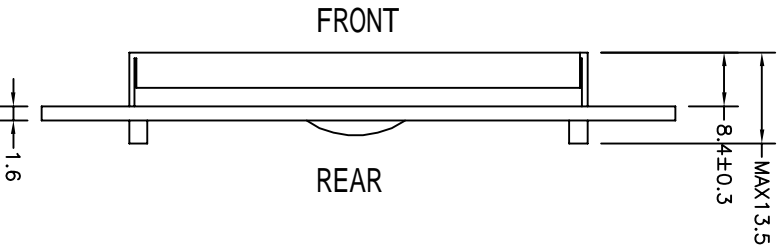
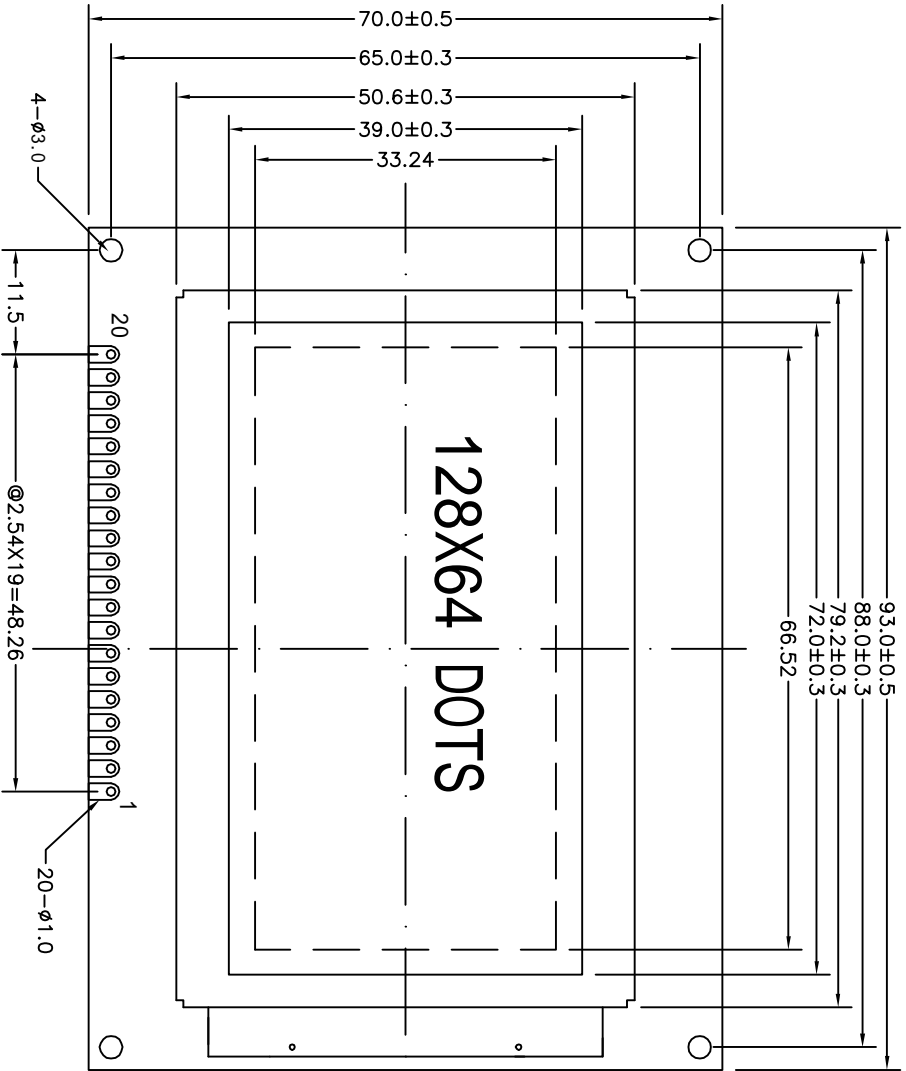

NOTES:

1. DISPLAY TYPE: STN-TRANSMISSIVE-BLUE
2. DISPLAY MODE: NEGATIVE
3. VIEWING DIRECTION: 6 O'CLOCK
4. VDD: 5.0 V
5. OPERATING TEMP: -20°C TO 70°C
6. DRIVER IC: ST7920(COB)
7. DRIVER METHOD: 1/32 DUTY 1/6 BAIS
8. BACK LIGHT: LED WHITE, IF=40mA,VLED=5.0V



深圳市华远显示器件有限公司  
SHENZHEN HUAYUAN DISPLAY CO., LTD

DESIGN	JHG	20080710	TECHNOLOGY	REV. : A	SCALE : -
CHECKED			Q.A	PROJECTION:	UNIT : MM
STANDARD			APPROVED		SHEET : 1/1

DRAWING No.: HJC1286401C-b162L-VBH

DRAWING TITLE : LCM

FILE NO.: 8